

### KEY FEATURES

- Complete car audio system
- Good power handling (80 w RMS / 160 w maximum)
- Extended frequency range (50-20000 Hz)
- Excellent sensitivity (92 dB)
- Glass fibre woofer cone
- Fabric tweeter diaphragm

### WOOFER SPECIFICATIONS

Nominal diameter	165 mm. 6.5 in.
Nominal impedance	4 ohms
Power handling / maximum	80 W RMS / 160 W
Sensitivity	90 dB 1w @ 1m
Frequency range	50 - 6000 Hz
Resonant frequency, fs	56 Hz
D.C. voice coil resistance, Re	3.6 ohms.
Mechanical quality factor, Qms	2.26
Electrical quality factor, Qes	0.98
Total quality factor, Qts	0.68
Equivalent air volume to Cms, Vas	13.2 l
Efficiency, ηo (%)	0.2
Effective surface area, Sd	130 cm <sup>2</sup>
Xmax	3 mm

### TWEETER SPECIFICATIONS

Nominal diameter	25 mm. 1 in.
Nominal impedance	4 ohms
Power handling / maximum	20 W RMS / 40 W
Sensitivity	92 dB 1w @ 1m
Frequency range	2 - 20 kHz

### FILTER SPECIFICATIONS

Power handling	120 W RMS
Crossover frequency	3.2 kHz
Attenuation slope	12 dB/oct.

### MOUNTING INFORMATION

Woofer baffle cutout diameter	147 mm. 5.79 in.
Woofer mounting depth	66 mm. 2.60 in.
Tweeter baffle cutout diameter	46.5 mm. 1.83 in.
Tweeter mounting depth	20 mm. 0.79 in.
Filter external dimensions	115 x 90 x 39 mm. 4.5 x 3.5 x 1.5 in.

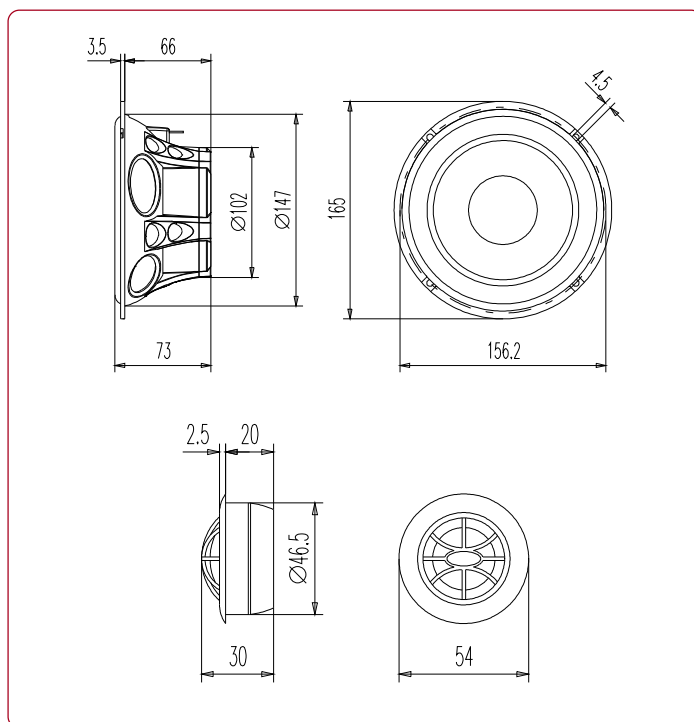

### FREQUENCY RESPONSE

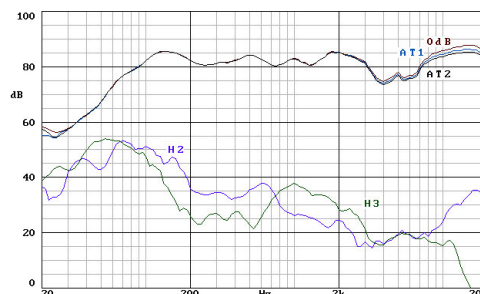

Note: on axis frequency response measured with loudspeaker standing on infinite baffle in anechoic chamber, 1w @ 1m.